



# TEFORIA

## **Teforia Infuser**

Setup Guide + User's Manual

---

Your tea journey  
begins here.



Can't wait to get started? Get ready to experience the true essence and flavor of tea. This guide will walk you through the setup of your new Teforia infuser. In this guide, we will...

-- Explain the setup process and get your infuser up and running.

-- Show you how to make your first cup of tea using our convenient Sips, a 100% recyclable container that holds our premium Teforia teas.

-- Explore the Teforia App and connect your infuser to WiFi so it always knows how to craft the best infusions and stays up to date.

Excited? Great! Let's begin.

We are here to help : [help@teforia.com](mailto:help@teforia.com)

xxx - xxx -xxxx

(M-F 8:00am to 5:00pm all time zones)

# Setting Up

10 minutes

# Making Tea

5 minutes

# Adding Teforia App

5 minutes

# Caring for Teforia Infuser

5 minutes

# Setting Up



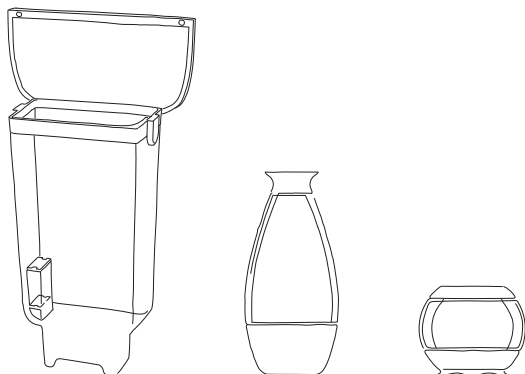

## Rinse

Your Teforia traveled a long way to get to you. It should be cleaned before infusing the first Carafe. Remove the tape holding the Water Reservoir in place. Lift it out of your Teforia using the handle located under the lid. Use mild dish soap (fragrance-free is preferred) and warm water to clean the Carafe, Infusion Globe, and Water Reservoir.

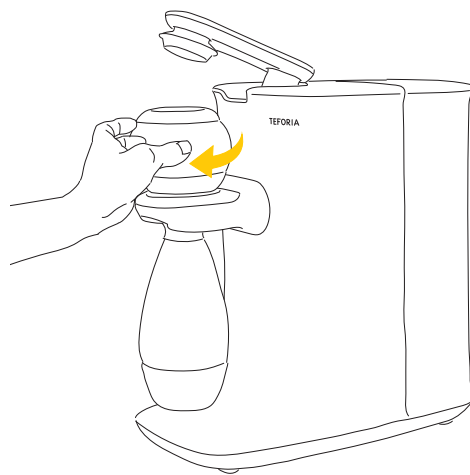

## Add Infusion Globe

Lift the infusion arm. Align the petals on the bottom of the Infusion Globe with the petals in the Nest. Gently rotate the Infusion Globe clockwise until it locks into place, and lower the arm.

When the Infusion Globe is not properly attached, the  icon will glow red. Please make sure it is rotated all the way in.

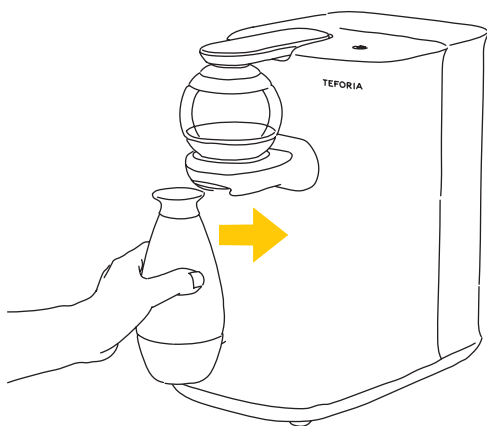

## Add Carafe

With a level motion, glide the Carafe straight into the infuser.  
You should hear a snap when it's securely in place.

When the Carafe is not properly secured, the 🍷 icon will glow red.

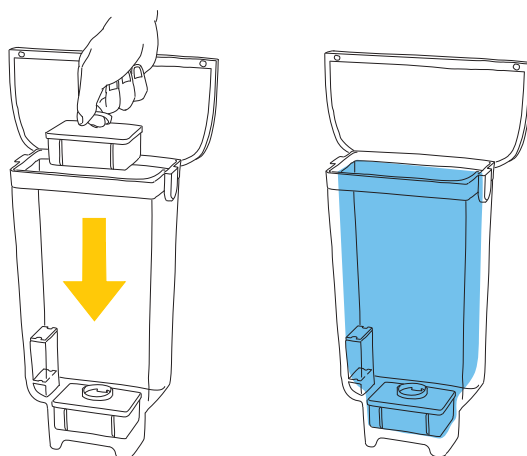

## Install Filter

Remove the filter from the packaging and rinse for 10 seconds. Open the lid on the top of the Water Reservoir and slide the filter into place. Please make sure the name Teforia on the filter faces outwards from the infuser. Then fill the reservoir with water.

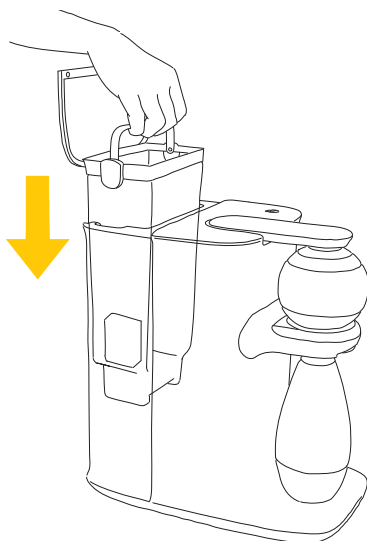
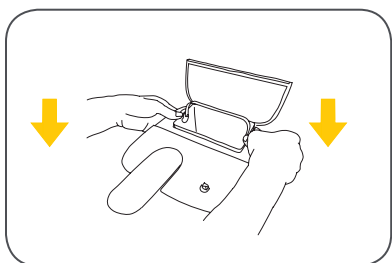

## Insert Reservoir

Please make sure the reservoir is completely seated by pushing down on the reservoir above where the metal handle connects.

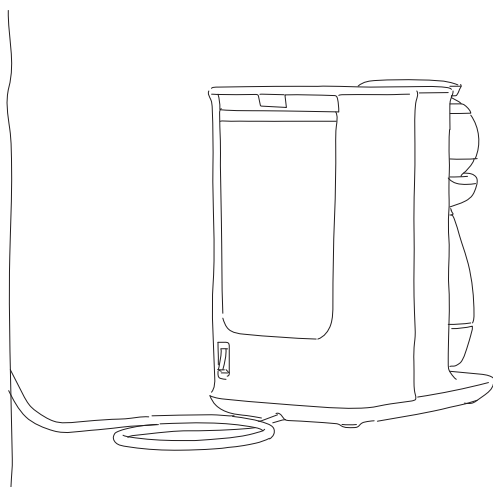

## Turn On

Plug in your Teforia, and turn it on. The power switch is at the rear of the Infuser. The icons will light in sequence, and your Teforia will chime when it is ready.

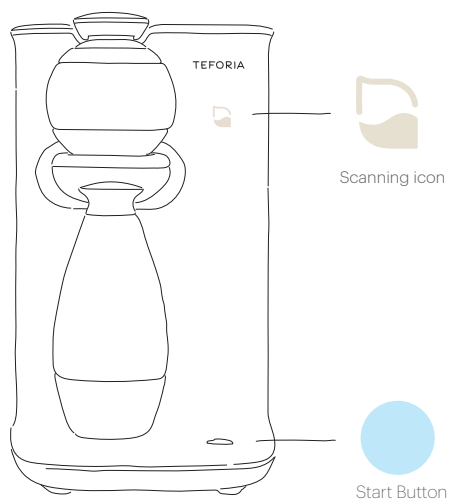

## Initial Clean Cycle

When you Infuser is turned on, you will hear another chime indicating the cleaning cycle is ready to be run. The *Scanning Icon* will illuminate in a soft glow, and the *Start Button* will be blue.

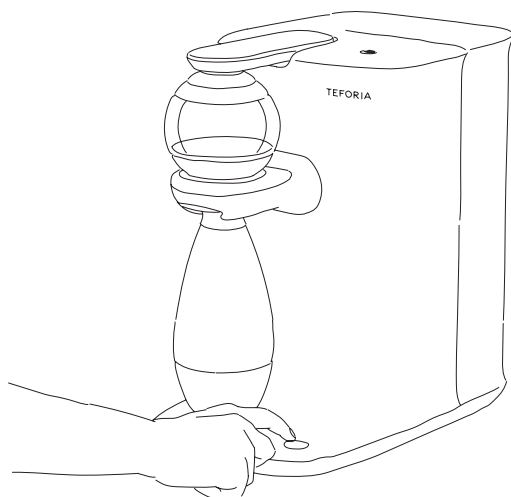

## Start Cleaning

Press the blue *Start Button* to begin the cleaning cycle. This process will take approximately 5 minutes to complete.

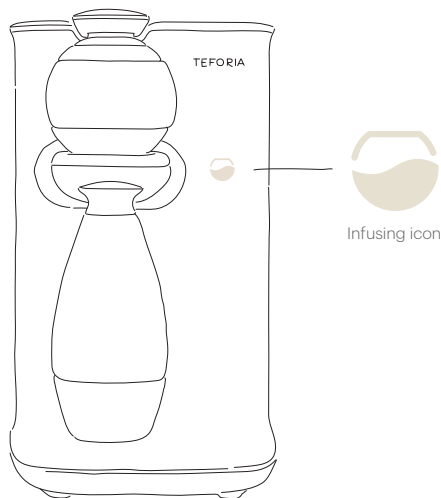

## Cleaning Cycle

You should see the *Infusing Icon* glow. Water will run through the Infusion Globe. Your Teforia will let you know when the Cleaning Cycle is done. Please do not remove the Carafe until cleaning is done.

We recommend running a Cleaning Cycle once a week. More information about cleaning your Teforia can be found in the Help section of the app or on **[help.teforia.com](https://help.teforia.com)**.

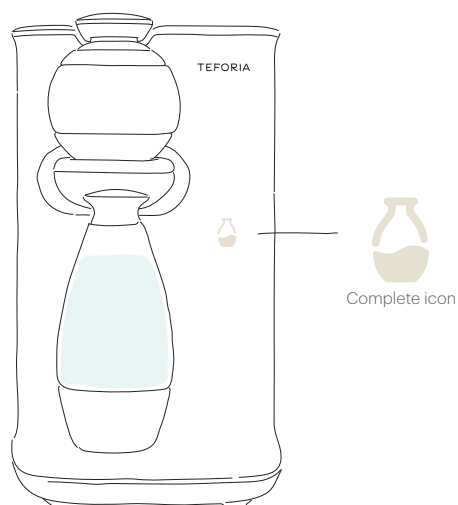

## Cleaning Complete

When the Cleaning Cycle has completed, the *Complete Icon* should glow, and you will hear a chime. Empty the water from the Carafe, and place it back into your Teforia.

# Making Tea





## Keepsake Box and Sips

Teforia teas are packaged in smart containers called Sips. An RFID tag is embedded in the label, which, when scanned, provides your Teforia with the specific recipe for that tea.

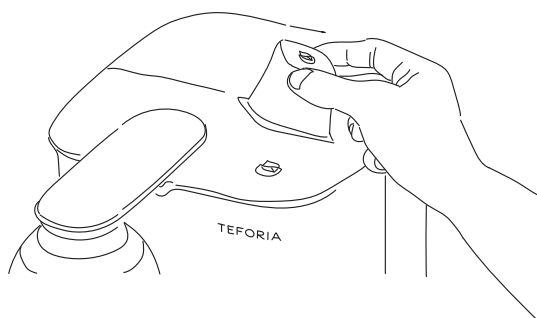

## How to Make Tea

Hold the Sips lid with the color label against the tea leaf logo at the top of your Teforia. Each Sips can be scanned multiple times over several hours. See **[help.teforia.com](https://help.teforia.com)** for more information.

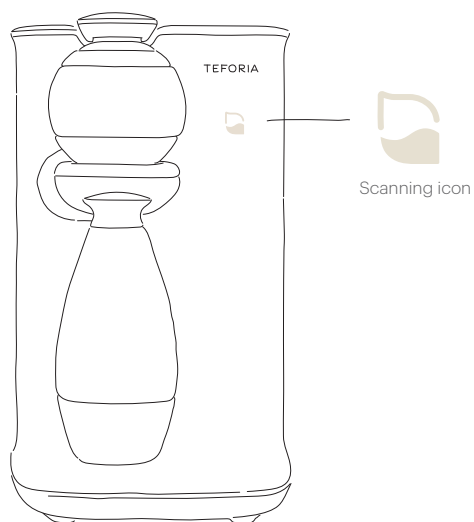

## Scanning Tea

Your Teforia will read the Sips, and the *Scanning Icon* will glow. The *Start Button* will also illuminate to let you know the Sips has been scanned.

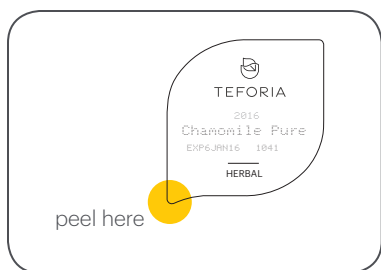

## Add Tea

Remove the Infusion Globe from the Infuser. Peel off the bottom left corner of the Sips to open it, and pour the tea into the Infusion Globe. Then twist it back onto the infuser.

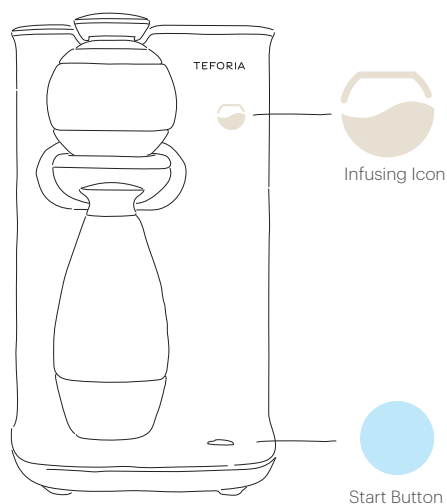

## Start Infusing

Press the *Start Button* to begin infusing. You will hear a chime, and the *Infusing Icon* will glow. Infusion time is recipe-specific and will typically range from 4–7 minutes.

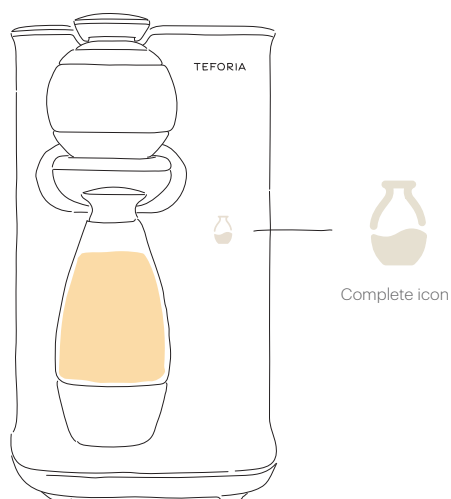

## Enjoy

Once the tea is done, the *Complete Icon* will glow. Enjoy a cup of tea right away, or leave it for a while. The tea will stay at temperature in the Carafe for up to an hour.

# Adding Teforia App



# Before you begin...

You will need an iPhone, iPad or Android device with Bluetooth enabled.

*\*Android users, please make sure location services are turned on as well.*

Connect your device to the WiFi network the Teforia infuser will use. Be sure it is not a guest network.

Please download the Teforia companion app using this link:  
**[teforia.com/app](https://teforia.com/app)**

The app allows you to explore teas, look at past infusions, shop for new teas and troubleshoot your Teforia infuser.



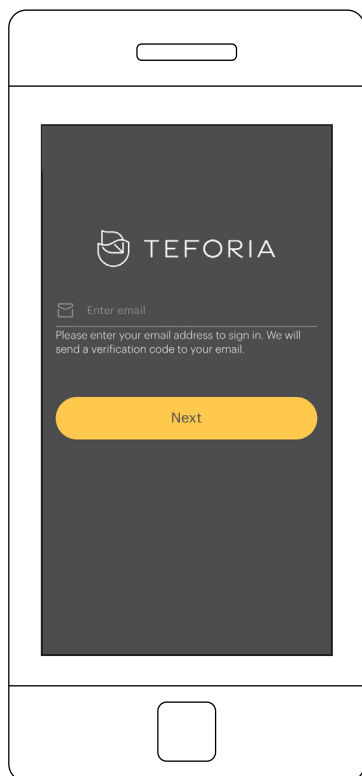

## Sign up

Enter your email address to receive a verification code and select **Next**.

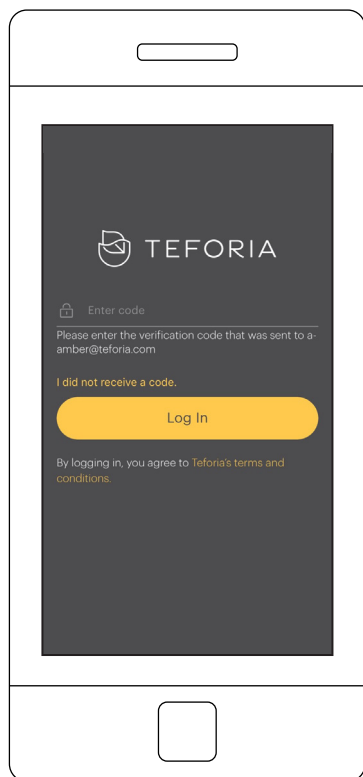

## Verify

Enter the verification code from your email, and select **Log In.**

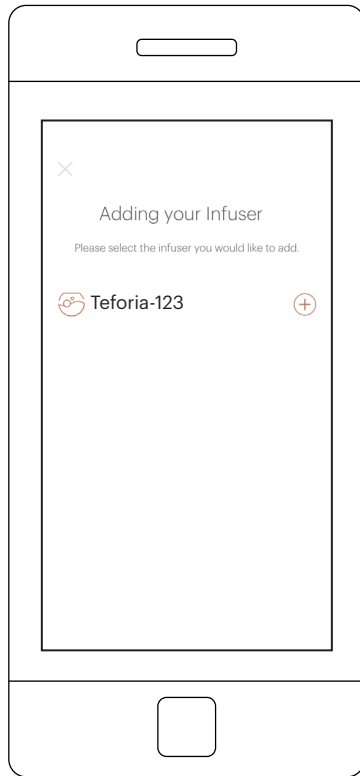

## Add Your Infuser

Select your infuser by tapping the plus sign. If asked, choose the WiFi network that your mobile device is using. Your Teforia infuser and mobile device **must** be on the same network.

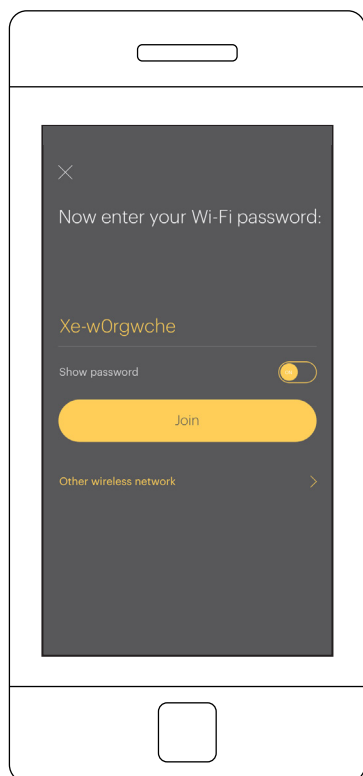

## Connecting Your Teforia Leaf

Enter the password for your WiFi network, and select join.

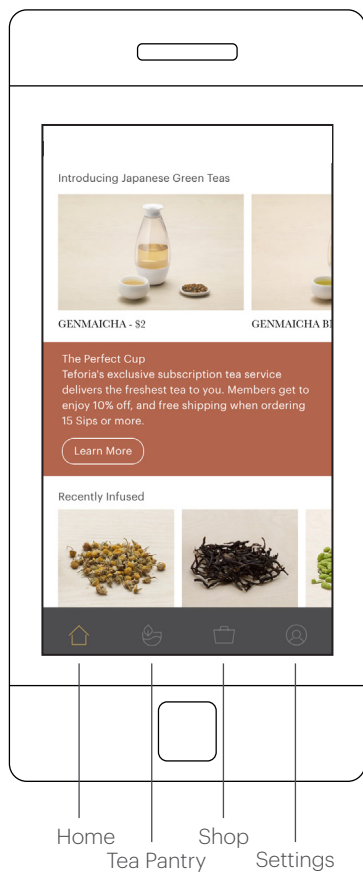

## Home

Explore our newest teas and review past infusions.

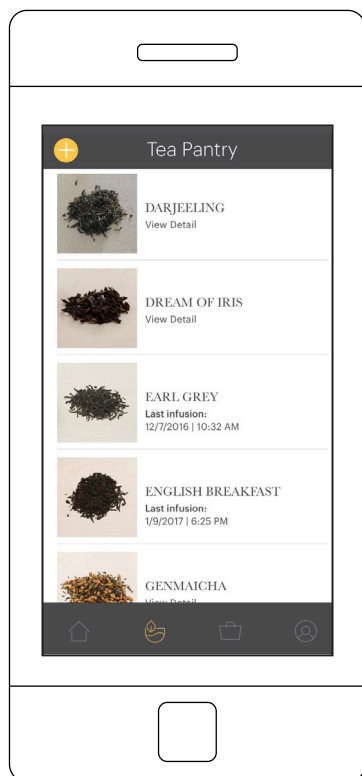

## Tea Pantry

The Tea Pantry is where you can learn more about the origin, harvest and history of our teas.

## Using Your Own Loose Leaf Tea

This feature is only available with Teforia Classic infuser.

From the Home Screen, select “Add a new tea” or from the Tea Pantry tap on the “plus sign.”

Answer a few key questions about the shape, color of the leaf, tea information, and tea category and the Teforia will identify the best-suited recipe. Select “Add My Tea” to save the tea.

Then, measure 4 grams of your tea, and pour the leaves into the Infusion Globe. In the app, tap “Select Tea” and then “Infuse” to begin the infusion process.

*Note: Do not exceed 4 grams of tea when using your tea for the first time.*

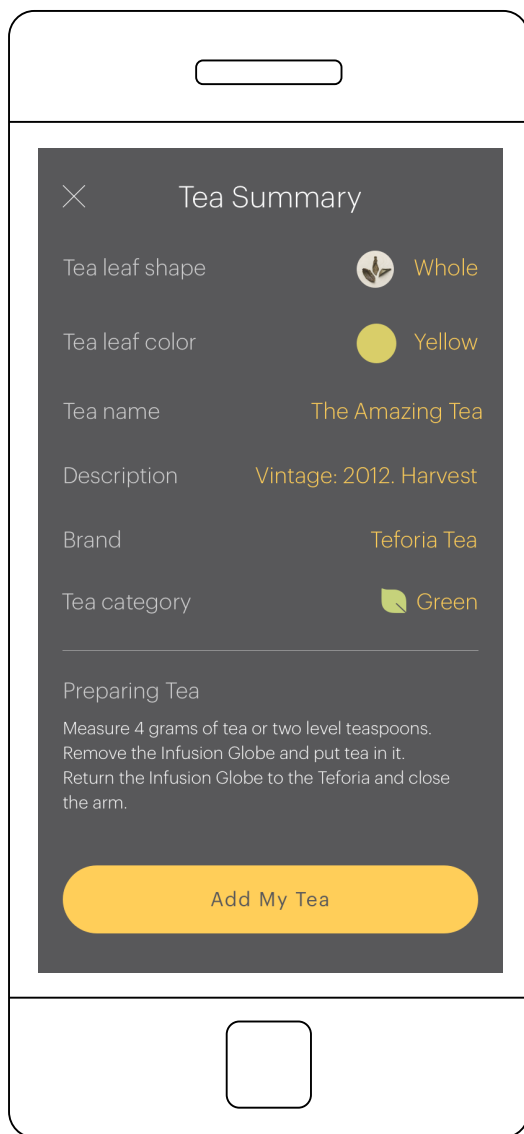

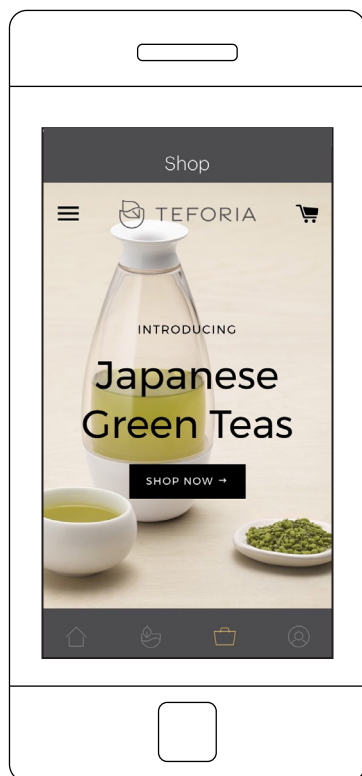

## Shop

In the Teforia shop, order your favorite Sips, and find new teas to enjoy.

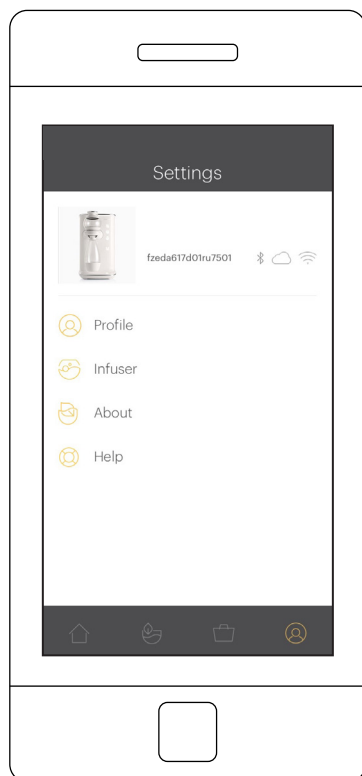

## Settings

In the companion app's settings, see the status of your Teforia infuser. You can also run a Cleaning Cycle, add a new infuser, reset your WiFi password, and check for system updates.

# Caring for Teforia Infuser



# Teforia Icons

The Teforia icons indicate when and how your infuser is in use and sometimes prompt action. This guide will help you identify what processes are under way and resolve any issues.



## Scanning

Soft Glow—The Sips has been successfully scanned.

Pulsing Blue Glow—Teforia is not connected to WiFi.

Solid Red—The Sips has been scanned too many times.



## Infusing

Soft Glow—The infusion process is under way.

Solid Red—Check that the Infusion Globe is properly secured and that the arm is in the proper position.



## Complete

Soft Glow—Infusion is complete.

Solid Red—The Carafe is missing or not securely in place.

## Low Water

**Pulsing Glow**—The water level is low, but there is enough for the infusion to complete. Be sure to add water before the next infusion.

**Solid Red**—The water level is too low to infuse. Refill the Water Reservoir.

*If the icon remains red with a full reservoir, remove the reservoir and re-seat it, making sure to secure it firmly.*

## Start

**Soft Glow**—Ready to begin infusion.

*If two Start Buttons illuminate, the button closer to the other icons will infuse the tea with a recipe designed to extract more caffeine.*

The *Start Button* stays lit for several minutes to give you time to load the tea into the Infusion Globe.

## Pulsing Icons



A set of pulsing red *Scanning*, *Infusing* and *Complete Icons* indicates an internal error. Your Teforia will reset itself. The Infusion Globe will empty the water into the Carafe. Empty the Carafe before starting the infusion again.

*If you power your Teforia off during this reset, the lights will continue to pulse after turning it back on until the infuser has completed its resetting process and run an infusion.*

# Care Instructions

## Daily Cleaning for your Teforia Infuser

Caring for your Teforia infuser is easy. After infusing, please blot dry the top and bottom of the Nest. Also dry the underside of the Infusion Arm.\*

*\*Note: The parts that need to be blotted dry are black in color.*

## Overall Care and Maintenance for your Teforia Infuser

- Blot dry the top and underside of nest and the infusion arm.
- Use the microfiber cloth and cleaning brushes provided with your Teforia. A small detail brush for cleaning the Infusion Globe can be found inside the handle of the large brush.
- Wash all of the components by hand.
- **Do not** place the Infusion Globe or the Carafe in the dishwasher. Doing so will damage them.
- Only use fragrance-free soap and warm water to clean the Infusion Globe, Carafe, and Water Reservoir.
- Do not use any abrasive chemicals or materials.
- Run a Cleaning Cycle at least once a week to keep your Teforia infuser operating in optimal condition.

## Carafe and Infusion Globe

- Between infusions of teas within the same varietal, clean with a simple warm water rinse.
- When switching teas with distinctive flavors, we recommend cleaning with fragrance-free soap and the Teforia brush.
- It is important to remove wet tea leaves from the globe as soon as you're done infusing. Leaving wet leaves for too long may encourage mold to grow.

## Water Reservoir

- Before cleaning, please remove the filter.
- Clean weekly to maintain overall system freshness.
- To remove, open the lid on the top of the Teforia, and pull up on the handle.

## The Teforia Infuser

- To keep the Teforia looking spotless, use water and the microfiber cloth to wipe down the exterior.

Visit **[help.teforia.com](https://help.teforia.com)** for more detailed information on the care and cleaning of your Teforia.

# The Perfect Cup of Tea

## *Microinfusions for Elevated Flavor*

What makes the Teforia different is a process called “microinfusion.” Rather than infusing the leaves just once, the Teforia performs three to five small infusions. These microinfusions accentuate desirable features while suppressing bitterness and astringency. The result is a rich, multi-layered liquor with an immense complexity of flavor.

## *A Sensory Experience*

The tea making experience taps into all senses—the smell of the leaves, the sound of trickling water, and the sight of the leaves slowly unfolding. Our design respects this. The transparent Infusion Globe and Carafe let you watch the leaves dance as they transform the clear water into a richly hued tea liquor. The Teforia removes manual error and guesswork—but not the enjoyment—from tea preparation.

### *World-Class Recipes*

We've spent years working with tea masters and growers to develop the best recipes for coaxing rich and layered flavors from every varietal of tea.

Your Teforia comes with hundreds of recipes, and when a new recipe is crafted, it is pushed to your infuser instantly via the cloud.

### *A Moment of Reflection*

From the moment you select a tea to the very last sip, everything is working together to put the *moment* at the center of your experience.

# Thoughtful Design

## *Teforia Carafe*

The Teforia Carafe is designed to be functional art—as beautiful on the infuser as it is on any dining table. It has stain-resistant borosilicate glass on the inside and BPA-free high-impact plastic on the outside to withstand daily use. The double-layer insulated design can hold the tea at temperature for up to an hour—and you'll never burn your hands.

## *Infusion Globe*

The Infusion Globe is also double-layer insulated. The inside is borosilicate glass, which is resistant to stain and aroma. The Infusion Globe ensures that the tea leaves and liquor never touch anything but glass, keeping the infusion process pure. Just like the Carafe, the Infusion Globe is surrounded with high-impact plastic, making it extremely durable.



## *Teforia Sips*

Teforia teas are packaged in perfectly portioned containers called Sips that are recyclable and 90% compostable. Each Sips lid contains an RFID tag that allows the infuser to automatically recognize what kind of tea you're infusing.



### Eco-friendly

100% recyclable, 90% compostable to minimize environmental impact and maintain sustainability.



### Smart Tech Integration

Encoded with detailed tea information including terroir, harvest season, packing date, and master-crafted recipes for perfect infusions.



### Resilient Packaging

Specially designed and constructed containers protect and preserve the precious tea leaves inside.

### *Prepare Your Sips for Recycling*

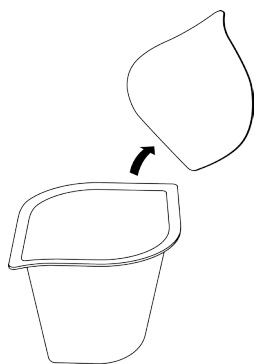

Remove lid and place in self-addressed return envelope to send back to Teforia.



Carefully separate the liner from the paper Sips container by peeling the bottom left corner.

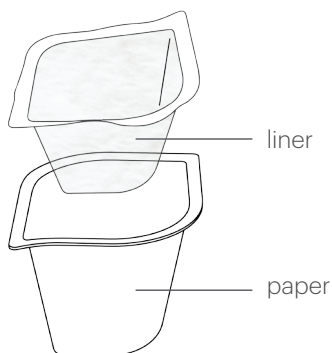

This liner is 100% recyclable and the paper container is fully compostable.





Tea like you've never tasted before.

